



# TECHNICAL DATA SHEET

## Product Overview

- The CENTRIA International DSR-J panels is a patented design, built for exterior wall applications, combining performance, quality and superior aesthetics.
- The panels consist of two metal layers permanently hot-pressed onto a fire-resistant mineral wool core.
- CENTRIA International DSR-J can be installed both horizontally and vertically, with customization available for widths, lengths, thicknesses, and joint requirements.
- Certified to meet international standards for fire resistant, insulation, waterproofing, and decorative features.

## Panels Material

<b>Metallic-Coated Steel Face Sheet</b>	<ul style="list-style-type: none"> <li>Zinc-coated (galvanised) steel sheet</li> <li>Face sheet thickness: 0.6 - 1.0 mm,</li> <li>Smooth/ embossed surface</li> </ul>
<b>Aluminum Face Sheet</b>	<ul style="list-style-type: none"> <li>Face sheet thickness 0.8 - 1.0 mm</li> <li>Smooth/ embossed surface</li> </ul>
<b>Exposed Coil-Coated Finish (Choose One)</b>	<ul style="list-style-type: none"> <li>Fluoropolymer Two-Coat System</li> <li>Fluoropolymer Two-Coat Thick Film System</li> <li>Fluoropolymer Three-Coat High-Build System</li> <li>Fluoropolymer Two-Coat Mica System</li> <li>Fluoropolymer Three-Coat Metallic System</li> <li>Fluoropolymer Two-Coat Corrosion and Abrasion Resistant System</li> <li>Urethane Two-Coat Corrosion and Abrasion Resistant System</li> <li>Fluoropolymer Three Coat System</li> </ul>
<b>Metallic-coated Steel Liner Sheet</b>	<ul style="list-style-type: none"> <li>Zinc-coated steel sheet</li> <li>Thickness 0.5 - 0.6 mm</li> <li>Smooth/ embossed surface</li> </ul>
<b>Mineral Wool Insulation Core</b>	<ul style="list-style-type: none"> <li>Standard density: 140 kg/m<sup>3</sup>, non-combustible, water-repellent, PH-balanced, non-corrosive</li> </ul>
<b>Bonding Adhesive</b>	<ul style="list-style-type: none"> <li>High bonding strength of ≥60 kPa, stable under extreme temperatures.</li> </ul>

## Technical Information

<b>Thermal Conductivity of Mineral Wool</b>	≤ 0.048 W/(m·K)
<b>Fire Resistance Rating</b>	Class A fire resistance
<b>Fire Resistance Limit</b>	≥ 90 minutes (100mm thickness)
<b>Bonding Strength</b>	≥ 0.19 MPa
<b>Peel Performance</b>	100%
<b>Bending Bearing Capacity</b>	≥ 0.8 kN/m <sup>2</sup>
<b>Air Infiltration Performance</b>	ASTME283-04 <0.01 cfm/ft <sup>2</sup> / <0.1 L/s/m <sup>2</sup> (Liner/sec)
<b>Water Tightness Performance</b>	ASTME331-00 10.65 psf (pound/sqft) 510 pa (pascal)

### Horizontal Application

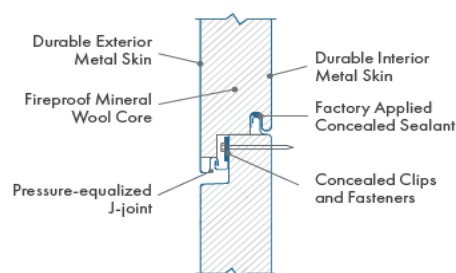

Horizontal:



Vertical:



## Unique Technical Advantages:

**100% Dry Seal:** The return face on panel ends eliminates the need for silicone, ensuring a cleaner and more efficient seal.

**Optimal Insulation:** Continuous mineral wool at panel joints enhances thermal performance.

**Smooth Finish:** Concealed fastening clips and screws provide a sleek and seamless appearance.

**Pressure-Equalized Air Space:** A double-joint interface featuring a unique "J" hook design enhances structural integrity and air pressure balance.

**High Flatness:** The hot pressing technique minimizes waviness, ensuring a consistently smooth surface.

**Stronger Bonding:** A precise and consistent adhesive application process improves durability and reliability.

## Thermal Performance

Product	Thickness (mm)	Thermal Conductivity Value W/(m.K)	Max. U Value W/(m <sup>2</sup> .K)	Min. R Value (m <sup>2</sup> .K)/W
DSR50	50	0.048	0.85	1.18
DSR80	80		0.56	1.79
DSR100	100		0.46	2.17
DSR120	120		0.38	2.63
DSR150	150		0.31	3.23
DSR175	175		0.27	3.80
DSR180	180		0.25	3.90
DSR200	200		0.24	4.32

# FINISHING SELECTION

## Classic Series

We love supporting our clients as they select the perfect colors for their projects. From standard shades to custom-tailored hues, we go the distance to ensure that the finish is as stunning as the design by providing color samples and expert guidance from our technical team. Based on the RAL® Color System\*, our Classic Series' vast array of colors beautify exterior and interior projects.

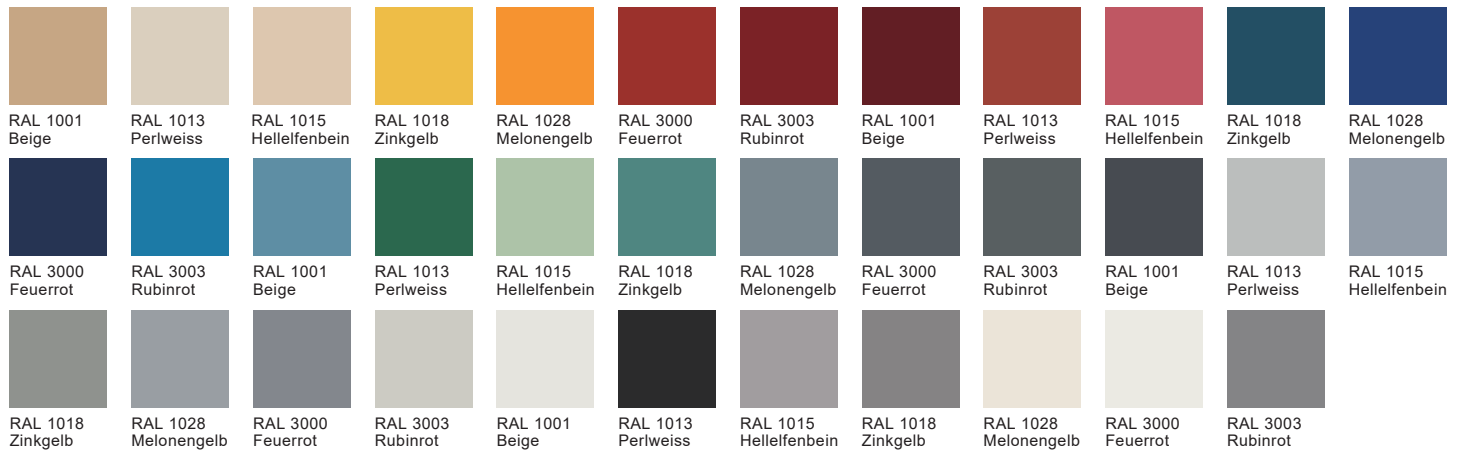

## Special Series

The innovative, high-performance custom colors in our Special Series make unique finishes possible. From pre-finished decorative Wood and Stoneware options that accurately and cost-effectively simulate expensive natural finishes, to our matte finish that features a subtle, aggregate stucco texture, and to the custom color requests that come from the brilliant architects and designers with whom we work, we love to help provide color and coating solutions that make building exteriors and interiors truly phenomenal.

### Wood Decor

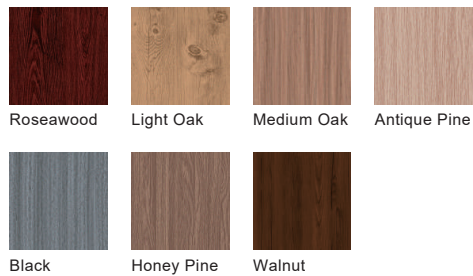

### Stoneware

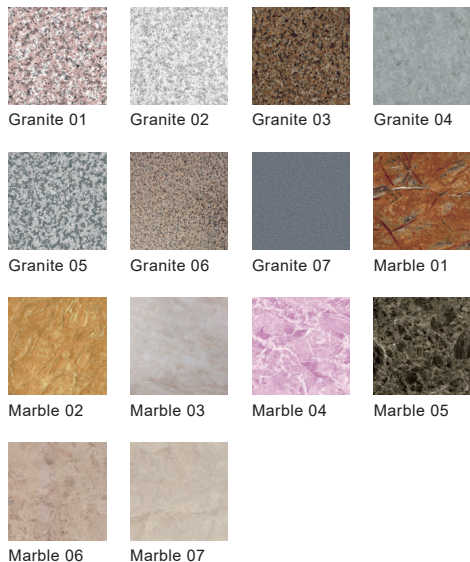

### Custom Finishes

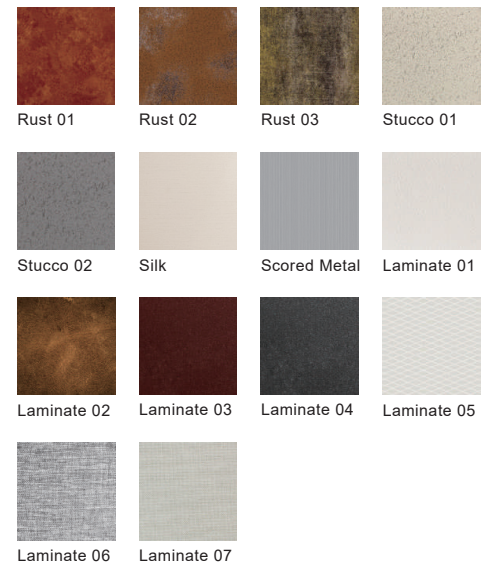

## Radiant Series

Our Radiant Series takes coating innovation and design inspiration to the next level by making it possible to create walls that feature dazzling micas, metallics, and our continuous, iridescent color-shifting gradients. Below please find a representative selection of popular options.

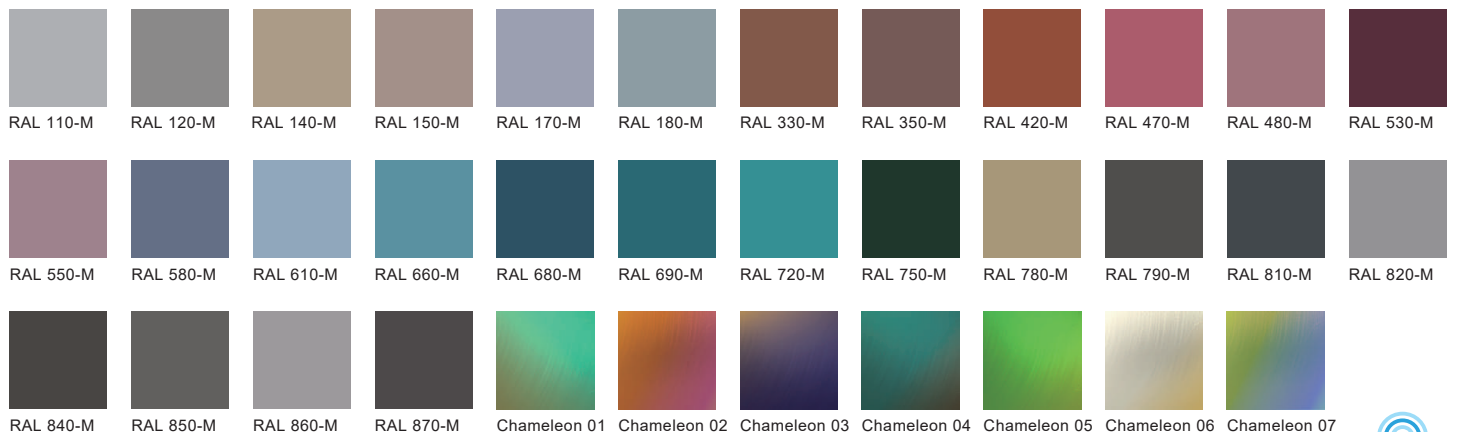

Please kindly note that all colors shown are for preliminary selection and may vary from the actual material. For sample chips or to learn more about our Colors and Coatings, please do not hesitate to contact your **PGF Global Distribution** Sales Manager.

\*Established in 1925, RAL is the leading color standard system for professional architects and designers. The RAL Color System is administered by RAL Deutsches Institut für Gütesicherung und Kennzeichnung e.V., an independent, non-profit organization.